

Parts Index: This set contains 41 3D Printed Parts, One 3D Clear Print and Eight Steel Tubes cut to length.

1. Nose Gear Leg	2. Nose Well Ceiling / Cockpit Floor	3. Nose Well / Cockpit Right Wall	4. Nose Well / Cockpit Left Wall
5. Main Wheel Wells	6. 7. 8.	12. 13. 14. 15.	16. 17. c.1
20. Nose Well Main Door	21. UHF Antenna	24a, 24b, 25a, 25b	26. 27. 28.
29. Nose Gear Door Actuator	32. Main Tires	33. Outer Main Wheel Hubs	34. Main Wheel Inner Hubs
35. Main Gear Stainless Steel Tubing, 2.34mm O/D x 17mm, 2 pcs.	36. Nose Gear Strut Stainless Steel Tube, 2.34mm O/D x 17mm	37. Main Landing Gear Retraction Strut Tubing, 0.89mm O/D x 12mm, 2 pcs.	38. Nose Gear Retraction Strut Stainless Steel Tube, 1.10mm O/D x 15mm
			Speedbrake Retraction Strut Stainless Steel Tubing, 0.71mm O/D x 10mm, 2 pcs.

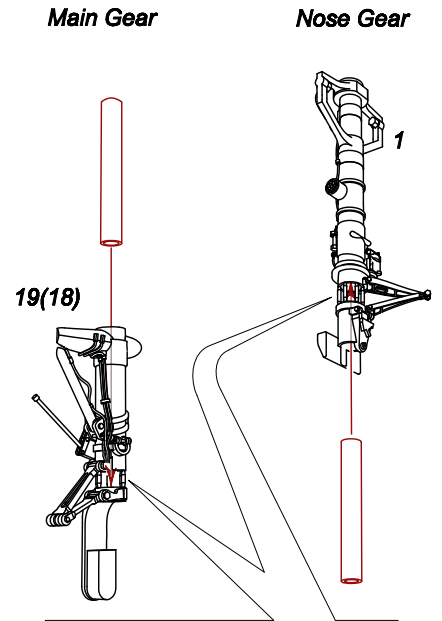

Note that these 'cage' structures serve some functions, one of which is to maintain correct geometry relative to everything above the torque links with everything below. Don't remove all of this cage...leave some of it strategically in place to allow you to insert the tube, and to still be able to get in there to apply glue. Make sure the tube is well secured to the strut, then remove the remainder of the cage.

NOTES:

Please be aware that the tubing supplied with this kit serves two equally important functions. First, it represents the oleo and retraction pistons extremely well. Achieving their desired look is very simple because of the material. It is very scuff resistant and needs no masking when painting the landing gear units. Primer, paint and overcoats simply scrape off, leaving a realistic sheen. Secondly, they provide structural integrity to the landing gear, and as such, they need to be securely adhered to the 3D printed parts, especially in the nose and main struts.

Study the following drawings carefully to understand how they relate to the Z-M kit. Important notes and comments are included intended to keep you on track with your modelling project. The Z-M long nosed F-4 kits are wonderful items with very clever engineering and we hope you agree that we have succeeded in elevating some of the finer details of the kit that are limited by injection molding technology to achieve the highest possible standard of what a plastic model can be. Enjoy your F-4 build!

Nose Gear Well

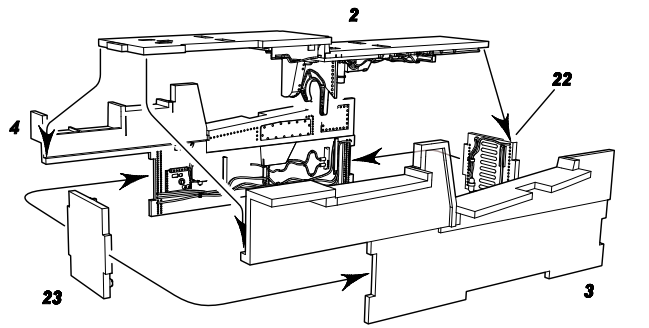

The parts shown immediately above directly replace their SWS equivalents and accept the kit cockpit details or aftermarket products designed to be used with them.

Main Gear Left Gear Shown

Remove the centre cross-brace details from the kit upper wing.

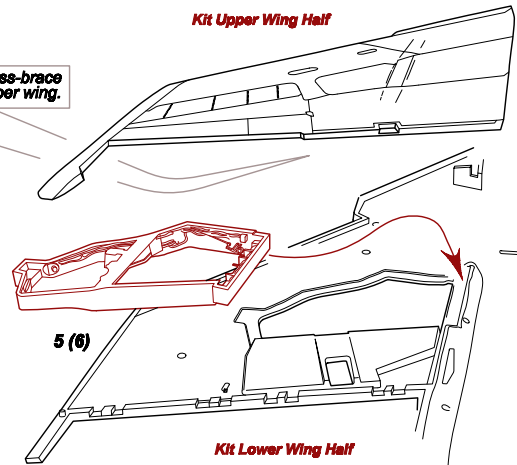

16 (17)

19 (18)

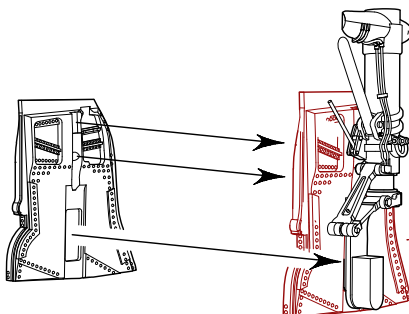

IMPORTANT! Take care to attach the Main Well Covers (16 and 17) securely to the Main Struts at the three points of contact. This will ensure the necessary structural integrity at the struts weakest points.

Nose Gear Leg

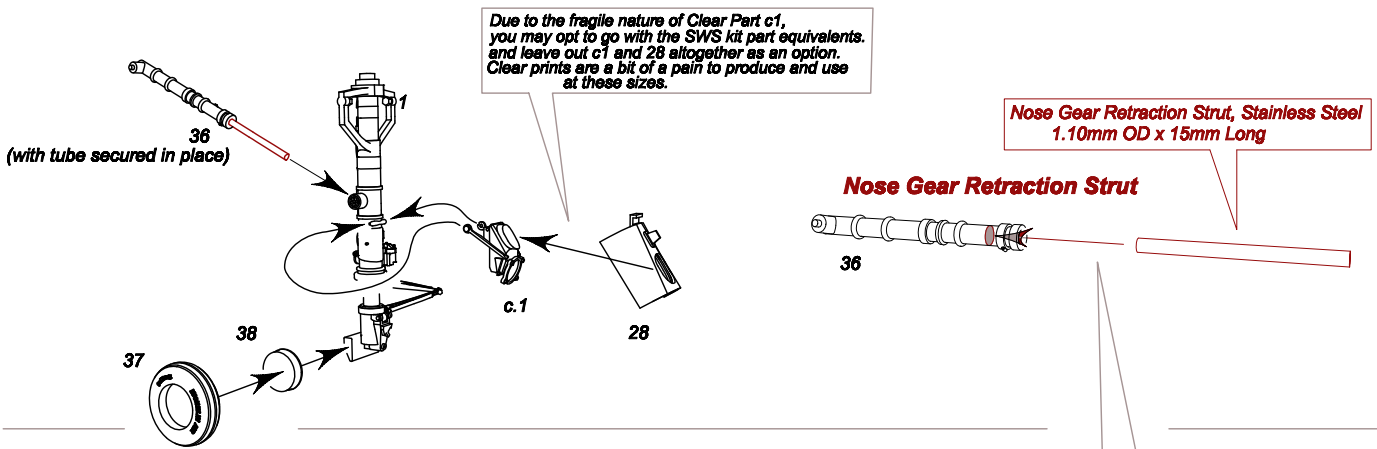

Main Gear Left Gear Shown

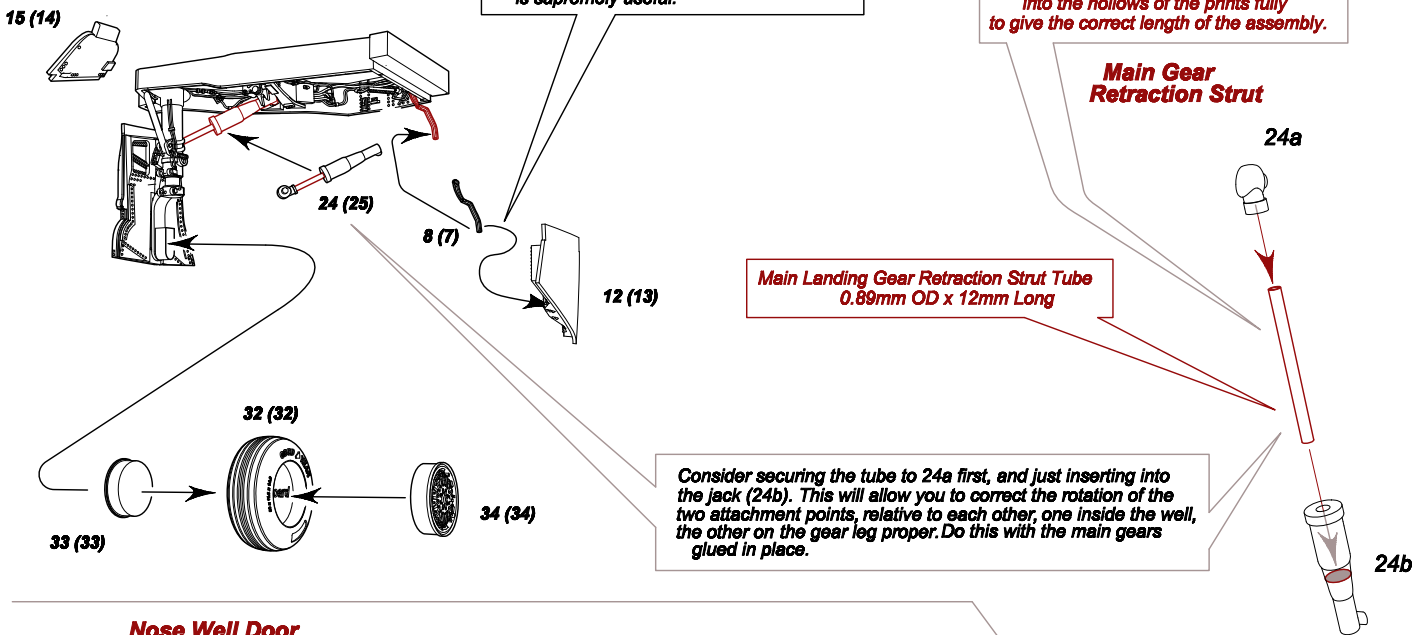

Nose Well Door (details omitted for clarity)

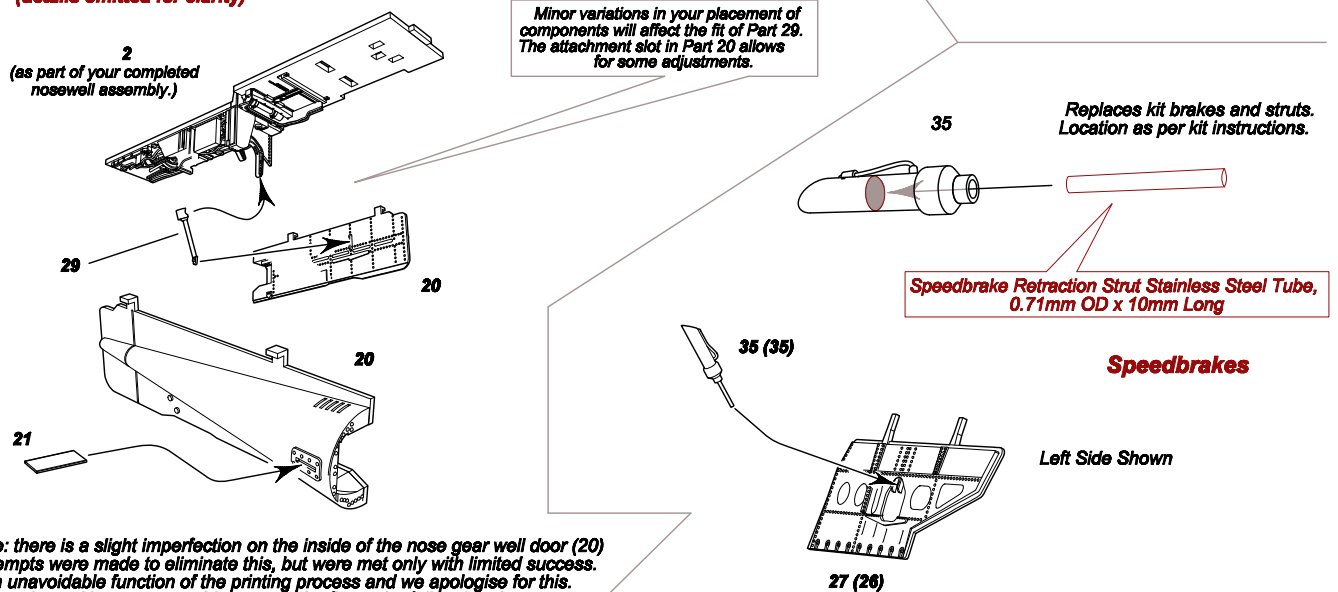

Please note: there is a slight imperfection on the inside of the nose gear well door (20) Several attempts were made to eliminate this, but were met only with limited success. This was an unavoidable function of the printing process and we apologise for this. Although not released in sequence, this set was the first to be fully printed, and so exhibits a few imperfections which we expect to be unnoticed.