

## Notes:

Use a fresh knife blade to sever the support attachment points from the actual parts

The resin we use for printing these parts is not particularly brittle, but is very delicate in some spots. The following indicates these spots, and a little extra caution should be exercised around these items both while separation from the supports and during general handling.

(\*) This is Part 1, the Main Gear Struts, and specifically points out the tie-down ring on the inside of the wheel hubs. There is a single support that leads to the ring, and this connection should be severed early on.

(\*) The other point to consider is also on Part 1, and involves the two end plugs at its top. A light slicing motion with a new knife blade will sever the connection without difficulty and will relieve stresses this section would be subjected to while handling.

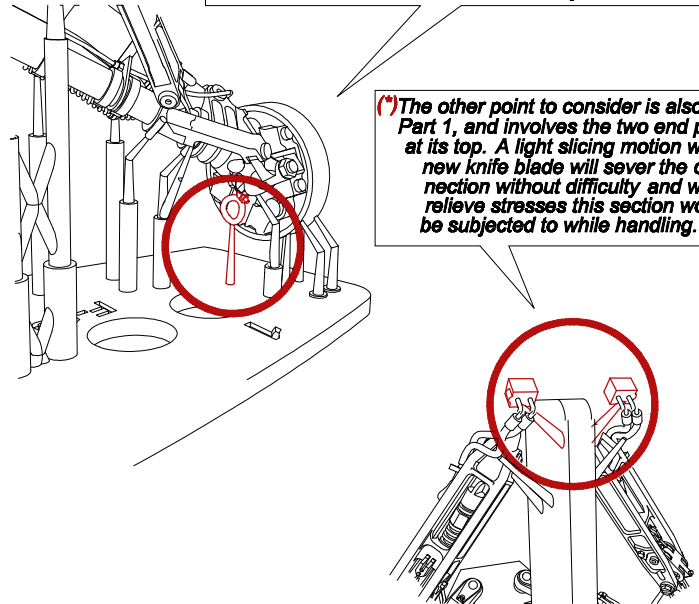

We have a rigorous QC system in place that involves frequent verification of all components. This includes confirming that all narrow openings designed to accept the tubing will do so without the need for unnecessary preparatory work on your part. Nevertheless, these items can be tricky to print every single time without the need to clean out the opening with a micro drill. Such items can be fixed, if actually necessary, by drilling out using the Parts Index as a guide, which supplies the tube diameters.

## Main Well

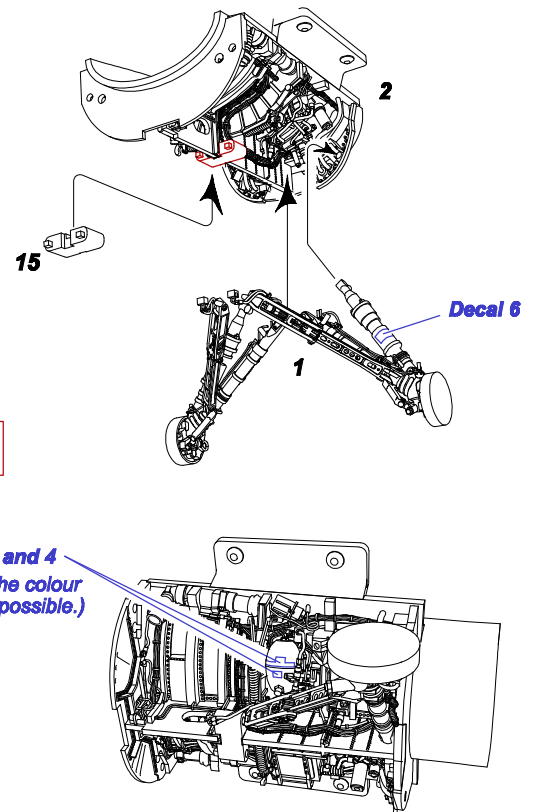

## PARTS INDEX:

This set contains 22 3D prints, 11 cut-to-length stainless steel tubes and a stencil data decal sheet.

1. Main Landing Gear Unit

2. Main Wheel Well

3. 4. MLG Door Brackets

5. 6. MLG Inner Struts

7. 8. MLG Door Retraction Struts

9. Nose Gear Strut

10. Nosewheel

11. Mainwheels

12. 13. MLG Retraction Units

14. Nose Gear Well

15. MLG Retraction Elbow

16. Nose Gear Brace

17. Left MLG Door

18. Right MLG Door

19. Older Style Nose Gear Door

20. Nose Gear Retraction Strut

21. Newer Style Nose Gear Door

**Stainless Steel Tubes (Cut-To-Length):**

MLG Door Retracts (2pcs) 0.81mm x 10mm	Nose Gear Strut 1.24mm x 12mm	Nose Gear and Nose Gear Door Retracts (2pcs) 0.71mm x 7mm
MLG Inner Sleeves (2pcs) 0.71mm x 21mm	MLG Retracts (2pcs) 0.56mm x 12mm	MLG Outer Sleeves (2pcs) 2.05mm x 8mm

Assembled components. Don't glue in the upper strut (5, 6) at this point, as you'll need to rotate it to sit in the wheel well properly. The inner sleeve runs the length of the Piston Strut to provide necessary strength. It should be glued in place to prevent long-term rotation of the gear.

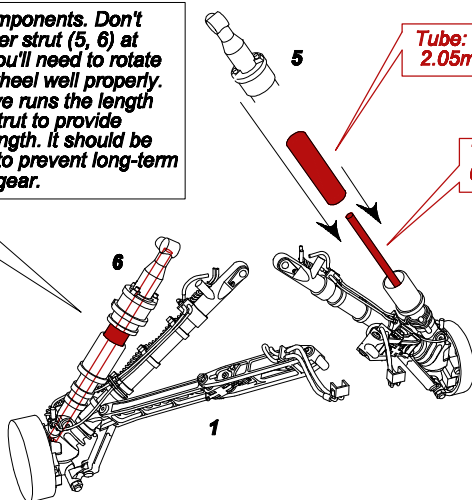

Decals 2 and 4  
(cut as close to the colour border as possible.)

(Right side shown)

This is the right Main Landing Gear Retraction Jack assembly. The left side is its mirror image. Insert the tube into the jack, but do not glue it in place just yet. The end of the tube should then be inserted into the pivot joint located on the main gear tension strut (\*). There is a relatively obvious hole designed to accept the end of the tube. The jack end of the assembly then inserts into the hole in the mid-well bulkhead as shown. The reason the tube should not have been glued in place first is that it should remain telescopic, aiding in the assembly installation. The use of a liquid tape material to hold one of the ends of the assembly in place while the other is positioned is recommended, but not absolutely necessary.

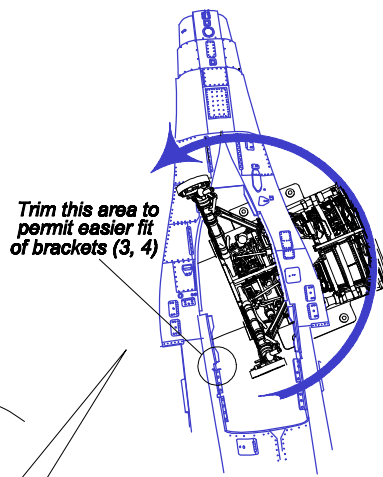
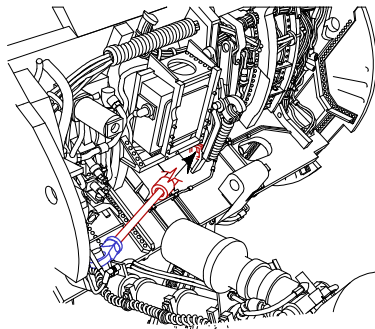
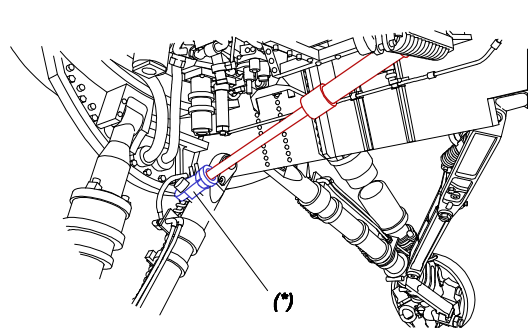
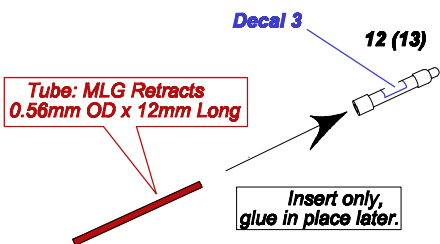

After attaching the upper half of the trunking above the wheel well (Kit Part J27) and the fan face (H2) as per the kit instructions, thread the assembly through the bottom fuselage as shown. Rotate the assembly to sit in the fuselage as indicated in the kit instructions.

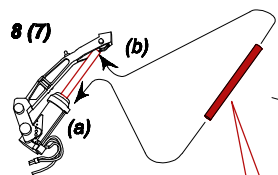

Tube: MGD Retracts 0.81mm OD x 10mm Long

Insert the tube all the way into the jack (a) and align it with the tip (b). There is a small tab that the tube slides over and sits on at end (b). It's a bit tough to see for its size, but it's there.

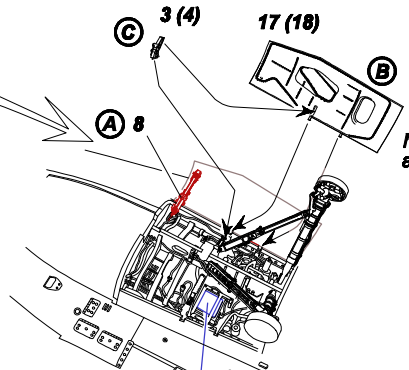

Assemble in the following order:

Note that these steps are completed only after the wheel well and struts (Parts 1 and 2) is installed in the fuselage.

- (A) Main Wheel Well Door Retraction Struts
- (B) Main Well Doors (be careful of correct alignment, left and right)
- (C) Main Wheel Well Door Brackets (3,4). These are best attached last, when the doors are secured in place.

Attach Mainwheels (11) at your leisure.

### Nose Well

Tube: Nose Gear Retract 0.71mm OD x 7mm Long

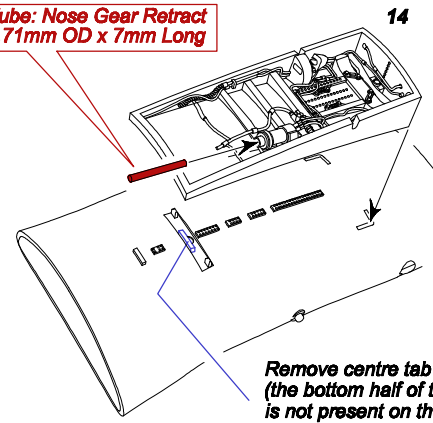

Decal 1 (Separate into two parts and cut along colour border).

Kit intake (H5 and H9) or Kazan's KAZ48021TAM Seamless Intake.

Remove centre tab if using Kit Part H5 (the bottom half of the intake). The tab is not present on the Kazan seamless intake (available separately).

It is highly recommended that the tubes for the Nose Gear Retract and the Nose Gear Door Retract be inserted into their respective locations but left unsecured with glue till all items in the nose well are in place and glued. A liquid glue product will aid in keeping them in place, while leaving them adjustable as needed.

Decal placement is indicated throughout as a matter convenience. Timing is up to you.

Decal 5 (spare provided - it's pretty small)

Tube: Nose Gear Door Retract 0.71mm OD x 7mm Long

