

This set replaces the corresponding Tamiya parts and also supplies the option of retraction struts with locking collars, so common on aircraft while on the ground.

Please be aware that the tubing supplied with this kit serves two equally important functions. First, it represents the oleo and retraction pistons extremely well. Achieving their desired look is very simple because of the material. It is very scuff resistant and needs no masking when painting the landing gear units. Primer, paint and overcoats simply scrape off leaving a realistic sheen. Secondly, they provide structural integrity to the landing gear, and as such, they need to be securely adhered to the 3D printed parts, especially in the nose and main struts (Parts 8, 10 and 11).

The nose and main gear struts have a printed support structure resembling a cage at the torque links. This is essential for the parts to print correctly and also to maintain the correct spatial geometry. It's best to not remove all of these connections prior to the installation of the tubes.

These parts are generally intended for use with the Tamiya kit wheel wells, reflected in the length of the various retraction struts. If you intend to install these gears into our wheel wells (KAZ48010TAM), slight modification to the struts may be necessary, but not difficult.

Study the following drawings carefully to understand how they relate to the Tamiya kit. Important notes and comments are included intended to keep you on track with your modelling project. The Tamiya F-4B is a phenomenal work of art with very clever engineering and we hope you agree that we have succeeded in elevating some of the finer details of the kit that are limited by injection molding technology to achieve the highest possible standard of what a plastic model can be. Enjoy your F-4B build!

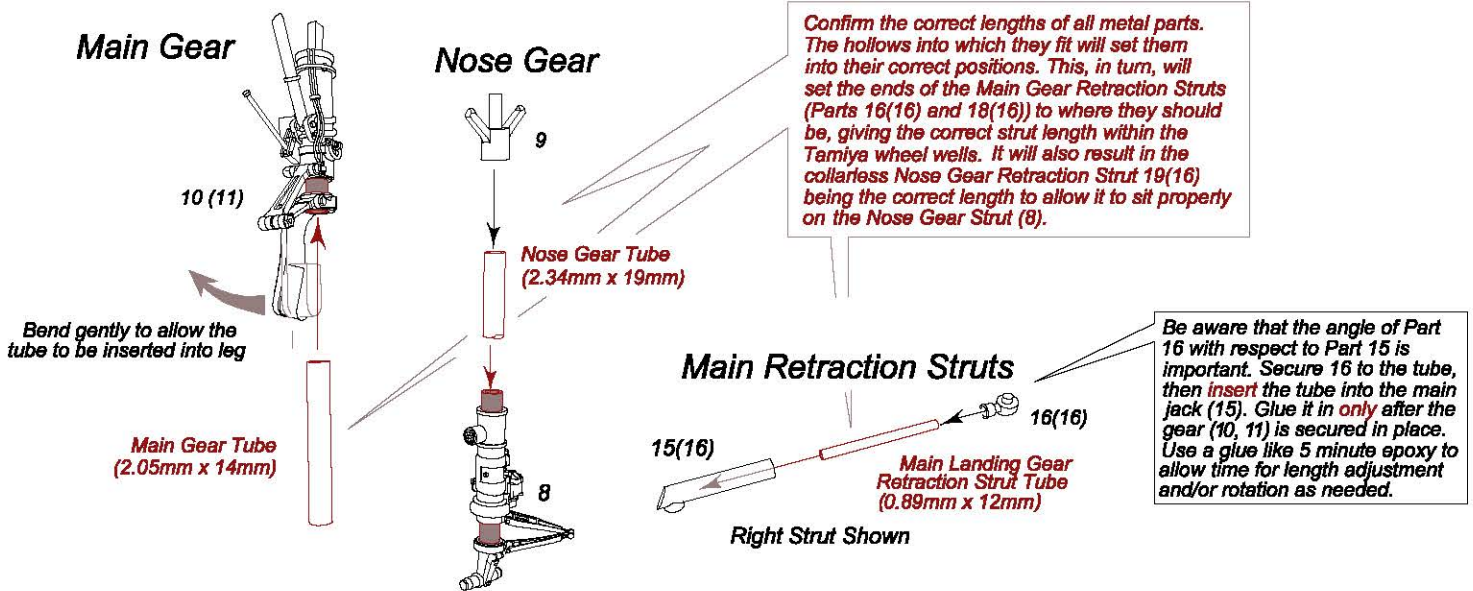

Please note that this set is intended to be used with the Tamiya kit wheel wells. This is reflected in the length of the retraction struts, but adjustments can be made to install this set using KAZAN's wheel wells by modifying their length (made possible by the telescopic nature of their design) or by simply eliminating the attachments points in the wells altogether.



Nose Gear

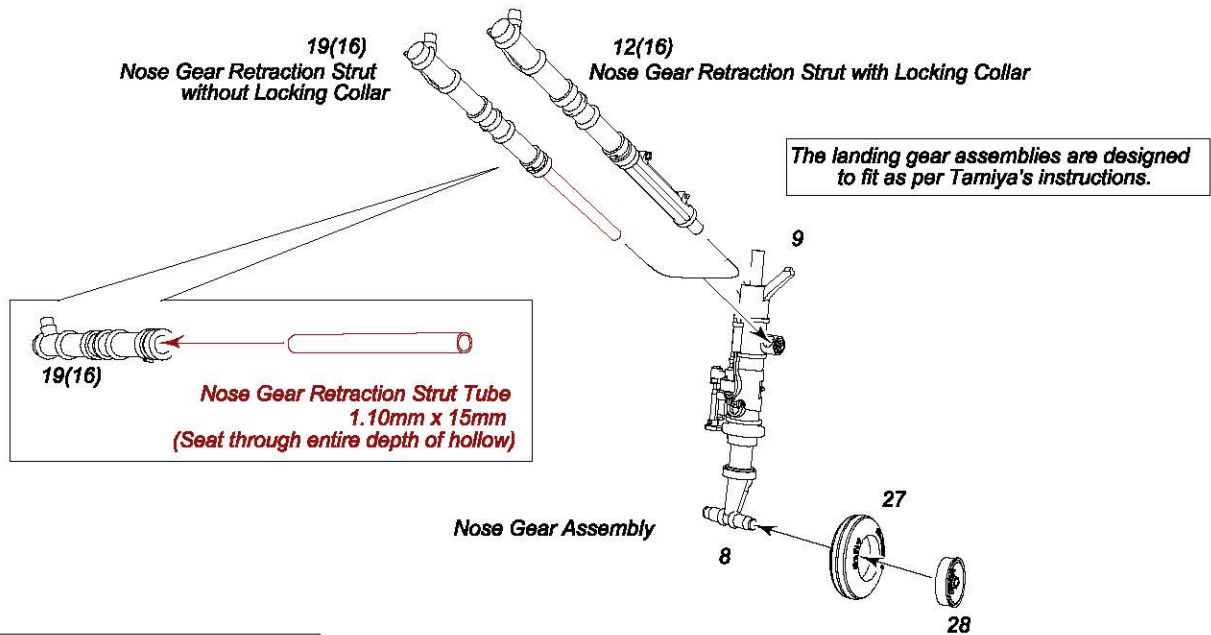

Note: the 16 numerals in brackets are not opposite side designators. These are used in our inventory system to differentiate between items that are designed to be used with the original Tamiya wheel wells, and those to be used with ours. Their variations are minor and are virtually interchangeable, if you disregard attachment points inside the wells.

Main Gear Left Gear Shown

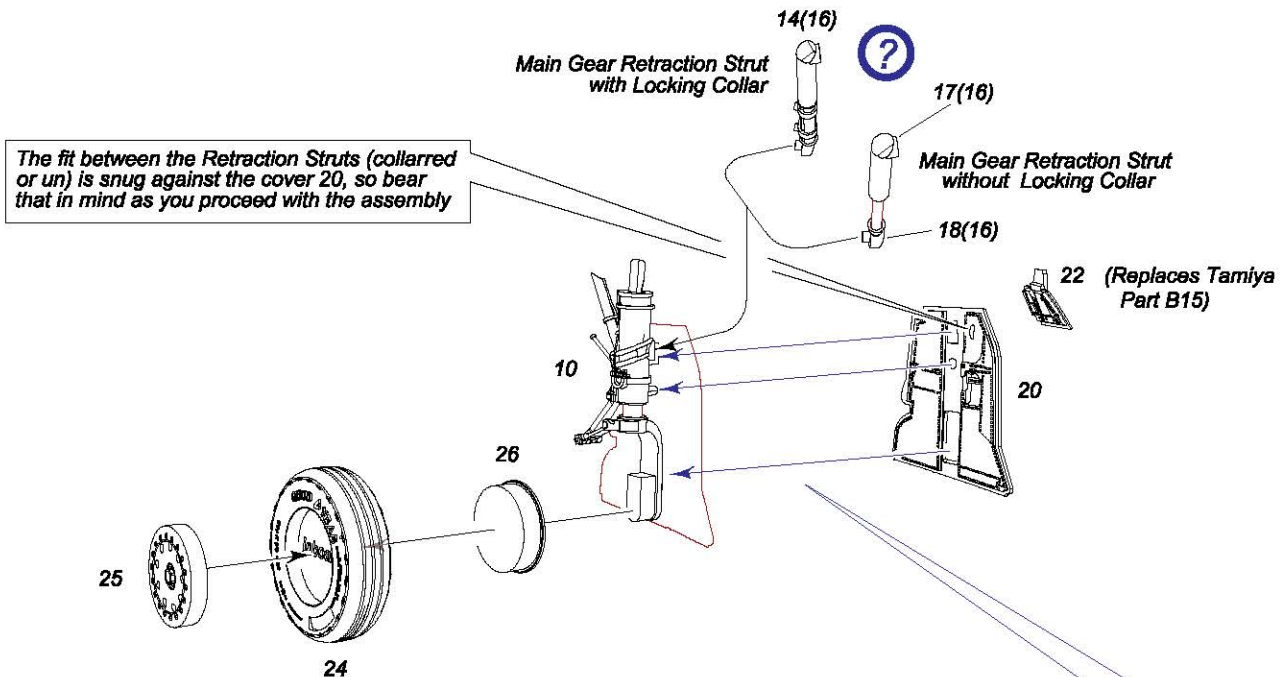

Please Note: The three blue arrows indicate the three points of contact between the gear proper (10) and the cover (20). It is essential that these points are solid connections as these will provide the necessary structural integrity for a permanently stable assembly.